

ELP CORES

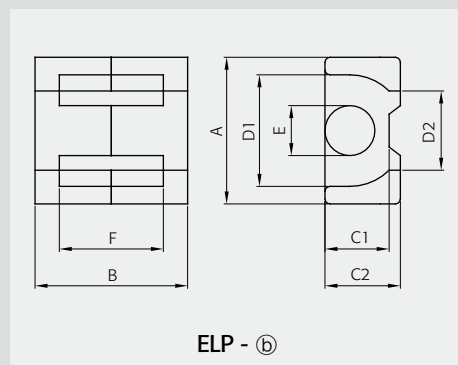
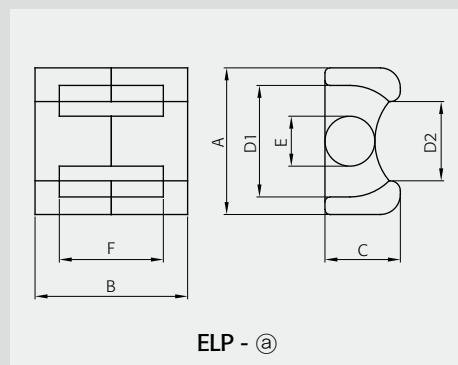

Part No.	ELP2532S	
Type	ELP - (a)	
Dimensions in mm	A	25.00 ±0.40
	B	31.80 ±0.20
	C	12.90 ±0.30
	C2	
	D	19.00 ±0.30
	D2	13.50 ±0.50
	E	8.60 ±0.20
F	24.10 ±0.30	

Core Set Parameters	C1(mm ⁻¹)	0.91
	Le(mm)	64
	Ae(mm ²)	70.3
	Ve(mm ³)	4500
	Ac(mm ²)	58.1
	Aw(mm ²)	125
	W(g/set)	30

Electrical Characteristics ⁽¹⁾⁽²⁾	Al. value	PL-7	2500
		PL-9	3100
		PL-11	2600
		PL-13	3290
		PL-15	2600
		SM-23T	2380
		SM-43T	4400
	ST-30B	3100	
	Core loss	PL-7	2.70
		PL-9	2.48
		PL-11	2.48
		PL-13	2.39
		PL-15	2.25

Note : 1) Core loss
 - Unit : Watt max.
 - Measuring conditions
 PL-7, PL-11, PL-15 : 100 kHz, 200mT, at 100°C
 PL-9, PL-13 : 100 kHz, 200mT, at 80°C

2) Al. value
 - Unit : nH/N²
 - Measuring conditions : 1kHz, 0.1V, 23°C
 - Tolerance : ±25%

	EP13F	EP17	EP20	EOP9.0	EOP9.5	EOP9.5D	ELP1205P	ELP1623S	ELP2522S
	EP - (a)	EP - (a)	EP - (a)	EOP - (a)	EOP - (a)	EOP - (b)	ELP - (b)	ELP - (a)	ELP - (a)
A	12.50 ±0.30	18.00 ±0.40	24.00 ±0.50	9.40 ^{+0.00} _{-0.4}	9.45 ±0.20	9.50 ^{+0.00} _{-0.40}	12.20 ^{+0.10} _{-0.40}	16.50 ±0.30	25.00 ±0.40
B	13.05 ±0.15	16.80 ±0.20	21.40 ±0.20	7.50 ^{+0.00} _{-0.20}	8.50 ±0.20	8.00 ^{+0.60} _{-0.00}	5.20 ±0.20	23.40 ±0.20	22.40 ±0.20
C	8.80 ±0.20	11.00 ±0.25	14.95 ±0.35	9.00 ^{+0.00} _{-0.40}	10.10 ±0.15	7.70 ^{+0.00} _{-0.30}	9.00 ±0.20	8.70 ±0.20	12.90 ±0.30
C2				5.60 ±0.20	6.50 ±0.15	5.74 ±0.10	7.30 ±0.15		
D	10.00 ±0.30	12.00 ±0.40	16.50 ±0.40	7.20 ^{+0.40} _{-0.00}	7.50 ±0.20	7.10 ^{+0.40} _{-0.00}	10.00 ±0.20	12.40 ±0.30	19.00 ±0.30
D2						4.50 ref.	8.60 ±0.20	8.50 min.	13.50 ±0.50
E	4.35 ±0.15	5.68 ±0.20	8.75 ±0.25	3.30 ±0.10	3.13 ±0.10	3.40 ^{+0.00} _{-0.20}	5.40 max.	5.70 ±0.10	8.60 ±0.20
F	9.40 ±0.20	11.30 ±0.30	14.30 ±0.30	4.60 ^{+0.40} _{-0.00}	5.46 ±0.20	4.70 ^{+0.40} _{-0.00}	3.00 ±0.20	17.40 ±0.20	16.40 ±0.30

C1(mm ⁻¹)	1.26	0.84	0.51	0.93	0.82	0.9	0.808	1.41	0.72
Le(mm)	24.6	28.5	39.8	15.4	19.5	19.3	15.4	44.1	49
Ae(mm ²)	19.5	33.9	78	16.5	23.8	21.4	19	31.3	67.9
Ve(mm ³)	480	966	3120	255	464	413	293	1380	3327
Ac(mm ²)	14.9	25.3	60.1	16.7	18.2	16.6	21.2	25.5	58.1
Aw(mm ²)	26	36	55	9.8	11.93	11.4	7.5	59	85
W(g/set)	4.8	12.3	28.5	2.1	2.8	2	1.8	9	20

Al. value	PL-7	1600	2400	4000	2100	2400	2300	2700	1500	3000
	PL-9	2200	3000	5020	2600	3100	2900	3400	1870	3750
	PL-11	1800	2500	4200	2200	2500	2400	2800	1600	3100
	PL-13	2330	3180	5320	2760	3290	3070	3600	1980	3980
	PL-15	1800	2500	4200	2200	2500	2400	2800	1600	3100
	SM-23T	1600	2400	3500	2000	2300	2200	2600	1450	2840
	SM-43T	3000	4500	6900	3700	3600	3800	4800	2700	5300
	ST-30B	2200	3340	4870	2800	3220	2900	3300	1900	3700
	Core loss	PL-7	0.29	0.58	1.87	0.15	0.28	0.25	0.18	0.83
PL-9		0.26	0.53	1.72	0.14	0.26	0.23	0.16	0.76	1.83
PL-11		0.26	0.53	1.72	0.14	0.26	0.23	0.16	0.76	1.83
PL-13		0.25	0.51	1.65	0.14	0.25	0.22	0.16	0.73	1.76
PL-15		0.24	0.48	1.56	0.13	0.23	0.21	0.15	0.69	1.66